

LD26 & LD26A

High Power Linear Reflector LED System



Data sheet - Page 1

LD26 comes in two versions. A symmetric 82° reflector (LD26) and the LD26A with an asymmetric reflector tilted at 8deg. By mounting the LEDs within a linear reflector, there is no uneven spotting from lenses or loss of output from just using the LED itself. Designed with the latest LED technology to create a continuous wash, the LED spacing is maintained across multiple lengths, so no dark spots! It offers great flexibility to the designer, with a range of options that suit most applications, details and project budgets.

Key Features

- Superb continuous lighting capabilities
- Maintained LED spacing across multiple lengths
- Reflectors focus the light to where it is needed
- Custom made lengths as standard, up to 2.1m
- Linked version available for curved applications
- High power for its compact size
- Available with Switched, 0-10V, DMX or Dali drivers

Specification

Applications



Beam Angles

LD26 - 82° & LD26A - 82° with 8° tilt

LED type

Cree XPG2

Colour temperature

2700K** / 3000K | 5000K

Drive Current (mA)	350	500	350	500
LED power* (W)	1.2W	1.7W	1.2W	1.7W
CRI (typical)	93	93	75	75
Forward voltage (V) ₁₀₀	3.0V	3.2V	3.0V	3.2V
LED spacing	Delivered lm/m** (L ₁₀₀)			
50mm	2027	2767	2463	3361
75mm	1318	1798	1601	2185
100mm	1014	1383	1232	1681
Lumens per circuit watt***	84	81	103	99

LED lifetime (to 70% lumen maintenance) 50,000hrs at a max ambient temperature of 35°C

Materials

Silver anodised aluminium body, PMMA acrylic lid, Aluminium reflector, ABS end caps.

Wiring

Comes pre-wired with 2m lead, can be specified with up to 10m at extra cost

IP rating

IP40 (IP54 available)

*LED wattage includes losses associated with using an 85% efficient driver

** 2700K lumen output is 12% lower than the 3000K figure listed

4000K lumen output is 14% higher than the 3000K figure listed (80 CRI)

***Data shown allows for 50mm spacing



Design: Fieldworks Design Consultants Product: Special LD25



LD26 & LD26A

High Power Linear Reflector LED System



Data sheet - Page 2

Fixing Options and Dimensions

Custom made lengths

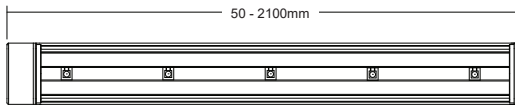

LED spacing maintained over multiple lengths

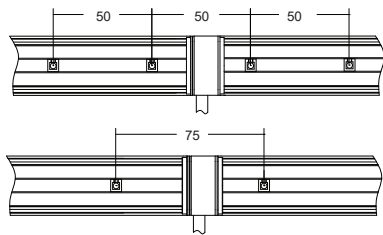

/SC
Spring Clip Fixing

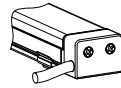

/BEM
Bracket End Mounting
Max 1000mm length

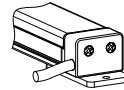

/BSM
Bracket Side Mounting

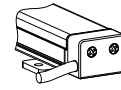

/ABM
Adjustable Bracket Mounting

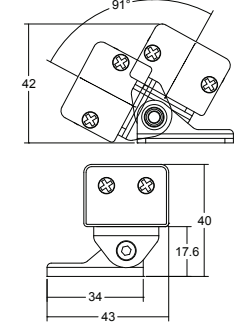
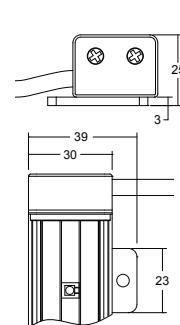
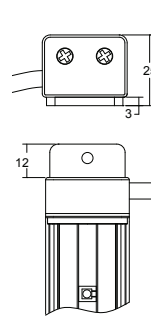
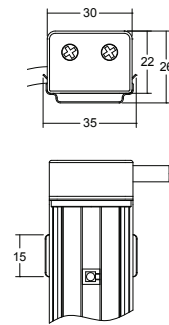
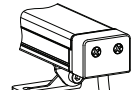

Cable entry is from the side as standard. With the adjustable brackets it is rear cable entry. (Dimensions in mm)

Reflector options

LD26
Symmetric

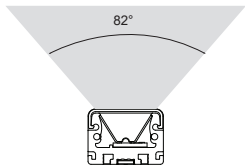

LD26A
Asymmetric

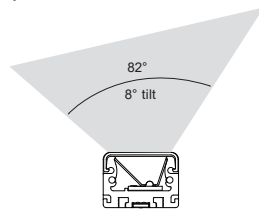

Linked sections

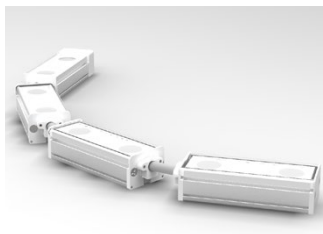

Around curves LD26 can be specified in smaller sections depending on the radius. These are hard wired together so the LED spacing is maintained.

Photometrics

Photometric files are included in the design pack which can be downloaded from the LD26/LD26A product page on the website.

Order Codes and Options

Product code	LED colour	LED spacing	Fixing option	Cable entry	IP rating	Length
LD26 (A) - 350 - 500	<input type="text"/>	<input type="text"/>	<input type="text"/>	<input type="text"/>	<input type="text"/>	<input type="text"/>

Example: LD26-500 / LW30 / 50 / ABM / SCE / IP40 / 1200mm

Product codes with output options

1.2W LED at 350mA	LD26(A)-350
1.7W LED at 500mA	LD26(A)-500

LED colour options

LED colour options	Suffix
Extra Warm White (2700K)	/LW27
Warm White (3000K)	/LW30
White (4000K) - on request	/LW40
Cool White (5000K)	/LW50

LED spacing

50mm	/50
75mm	/75
100mm	/100

Fixing options

Spring clips	/SC
Bracket end mounting (max length 1.2m)	/BEM
Bracket side mounting	/BSM
Adjustable bracket mounting	/ABM

Cable entry options

Side cable entry	/SCE
Rear cable entry	/RCE
End cable entry	/ECE

IP rating

IP40 (internal use as standard)	/IP40
IP54 rated for moist environments	/IP54

Use with 350mA and 500mA constant current LED drivers

We have a wide range of dimmable LED drivers, 0-10V, DMX, DALI and Mains dimmable. Please see the downloads section on our website.